

# DS-2CE55A2P(N)-IRM

## 700TVL DIS Outdoor IR Dome Camera

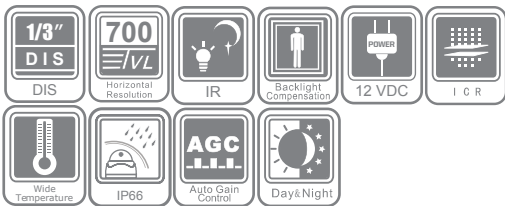

### Key features

- 700 TVL Horizontal Resolution
- True Day/Night
- 2.8/3.6/6mm Fixed Lens, 0.1 lux /F1.2
- 20m IR Distance
- Wide Operating Temperature Range: -40°C to 60°C(-40°F to +140°F)

### Dimensions

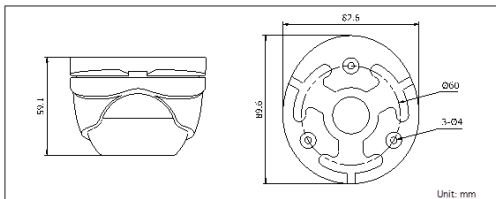

DS-2CE55A2P(N)-IRM	
<b>Camera</b>	
Image Sensor	1/3" DIS
Signal System	PAL/NTSC
Effective Pixels	976 (H) × 496 (V)
Min. Illumination	0.1 Lux @ (F1.2,AGC ON), 0 Lux with IR
Shutter speed	PAL: 1/50 s to 1/100,000 s NTSC: 1/60 s to 1/100,000 s
Lens	3.6 mm (2.8mm,6 mm optional)
	Angle of view: 68.4° (3.6 mm)
Lens Mount	M12
Angle Adjustment	Pan: 0 - 360°, Tilt: 0 - 75°, Rotation: 0 - 360°
Day & Night	IR cut filter with auto switch
Horizontal Resolution	700 TVL
Synchronization	Internal synchronization
Video Output	1Vp-p composite output (75 Ω/BNC)
S/N Ratio	More than 62 dB
<b>General</b>	
Working Temperature/ Humidity	-40 °C - 60 °C (-40 °F - 140 °F) Humidity 90% or less (non-condensing)
Power Supply	12 V DC
Power Consumption	Max. 1.8W (Max. 4W with IR cut filter on)
Ingress Protection	IP66
IR Range	20 meters
Dimensions	89.6 × 59.1 mm (3.53" × 2.33")
Weight	400 g (0.88 lbs)

### Order Models

DS-2CE55A2P-IRM  
DS-2CE55A2N-IRM

### Accessories



DS-1229ZJ-1  
(Wall Mount)



DS-1239ZJ-1  
(Wall Mount)